

## SAMPLE SITE PLAN

Sample Lot with a Lot Size of 30' x 120' = 3600 square feet

1. Draw site plan to scale, showing the property dimensions.
2. Indicate all existing structures on the lot, showing the dimensions of each and the setbacks to the property lines.
3. Indicate the proposed construction, showing dimensions and setbacks to property lines.
4. Indicate the street name or street names (if corner property) on the site plan.
5. Fill out the coverage chart to determine building/impervious coverage.

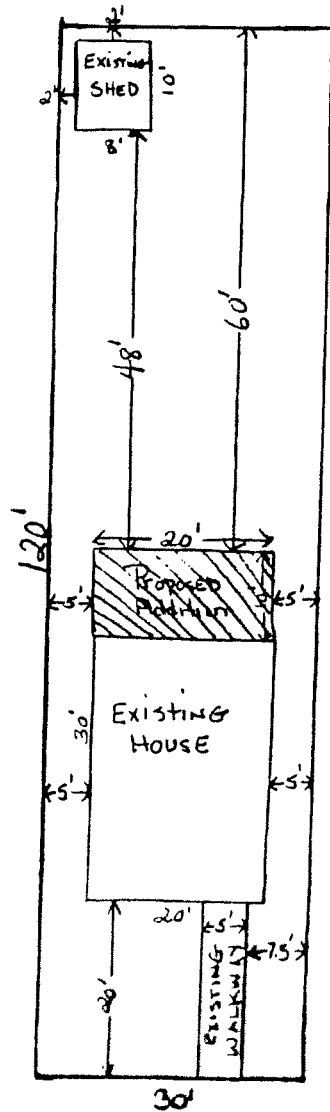

STREET NAME

Proposed Work



Scale: 1" = 20'

**BUILDING/IMPERVIOUS COVERAGE CHART**

ADDRESS: \_\_\_\_\_

ZONING DISTRICT: \_\_\_\_\_

LOT SIZE IN SQUARE FOOTAGE: \_\_\_\_\_

IMPERVIOUS PERCENTAGE ALLOWED: \_\_\_\_\_

BUILDING PERCENTAGE ALLOWED: \_\_\_\_\_

TOTAL % OF IMPERVIOUS COVERAGE PERMITTED: \_\_\_\_\_

TOTAL % OF BUILDING COVERAGE PERMITTED:  
(this is the lot size multiplied by the % allowed) \_\_\_\_\_

Indicate the square footage of the following:

**IMPERVIOUS:**

**BUILDING:**

House: \_\_\_\_\_

Driveway: \_\_\_\_\_ N/A

Shed(s): \_\_\_\_\_

Garage(s): \_\_\_\_\_

Walkway(s): \_\_\_\_\_ N/A

Concrete patio(s): \_\_\_\_\_ N/A

Other: \_\_\_\_\_

Total existing: \_\_\_\_\_

New Proposed Construction: \_\_\_\_\_

Grand Total Coverage: \_\_\_\_\_

Approved                  Denied

Zoning Officer Signature: \_\_\_\_\_

**BUILDING COVERAGE:** The ratio obtained by dividing the maximum horizontal cross section of all principal and accessory buildings on a lot (including balconies and decks, roofed porches, roof carports and roofed breezeways, but excluding patios) by the total area of the lot upon which the buildings are located.

**IMPERVIOUS COVERAGE:** Surface that does not absorb water, including all buildings, parking areas, driveways, roads, sidewalks, and any areas of concrete, asphalt, and packed stone, and any other areas determined to be impervious by the Borough Engineer.