

# SAMPLE SITE PLAN

Sample Lot with a Lot Size of 30' x 120' = 3600 square feet

1. Draw site plan to scale, showing the property dimensions.
2. Indicate all existing structures on the lot, showing the dimensions of each and the setbacks to the property lines.
3. Indicate the proposed construction, showing dimensions and setbacks to property lines.
4. Indicate the street name or street names (if corner property) on the site plan.
5. Fill out the coverage chart to determine building/impervious coverage.

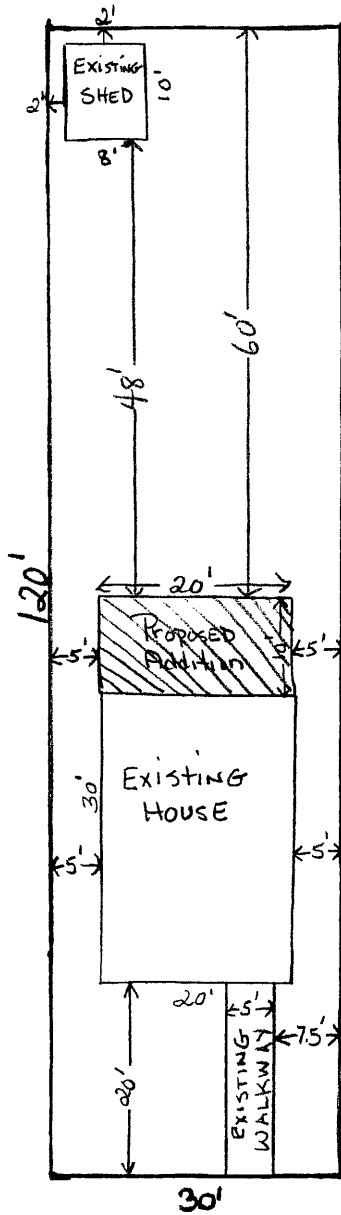

STREET NAME

Proposed Work

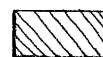

Scale: 1" = 20'

**COVERAGE CHART**

**ADDRESS:** \_\_\_\_\_

**LOT SIZE IN SQUARE FOOTAGE:** \_\_\_\_\_

**PERCENTAGE ALLOWED:** \_\_\_\_\_

**TOTAL % OF COVERAGE PERMITTED:** \_\_\_\_\_  
**(this is the lot size multiplied by the % allowed)**

**Indicate the square footage of the following:**

**House:** \_\_\_\_\_

**Driveway:** \_\_\_\_\_

**Shed(s):** \_\_\_\_\_

**Garage(s):** \_\_\_\_\_

**Walkway(s):** \_\_\_\_\_

**Concrete patio(s):** \_\_\_\_\_

**Total existing:** \_\_\_\_\_

**New Proposed Construction:** \_\_\_\_\_

**Grand Total Coverage:** \_\_\_\_\_

**Approved**                      **Denied**

**Zoning Officer Signature:** \_\_\_\_\_